

RL-9750-1VM

THRU-HOLE AC LINE FILTER

DESCRIPTION

- Thru-Hole AC Line Filter

ENVIRONMENTAL DATA

- Storage temperature range: -55°C to +130°C
- Operating temperature range: -40°C to +130°C

PACKAGING INFORMATION

- Packaging information: pg. 495

FEATURES & APPLICATIONS

- Easy PCB mounting
- High self-resonant frequency
- Used to reduce conducted EMI
- Small size and light weight
- Dielectric withstanding voltage rated at 2500 VAC line to line
- Signal line filtering

Verify operation with sample in actual circuit. Order samples at www.rencousa.com.

MECHANICAL DIMENSIONS

U.S. Standard (mm)

PART NUMBER	A (MAX.)	B (MAX.)	C (TYP.)	D ±0.02 (0.50)	E (MAX.)	F ±0.02 (0.50)
RL-9750-1VM	0.87 (22.00)	0.89 (22.50)	0.20 (5.00)	0.51 (13.00)	0.67 (17.00)	0.39 (10.00)

PART NUMBER	PART WEIGHT
RL-9750-1VM	9.0g (0.32oz)

G ±0.002 (0.05)	H ±0.002 (0.05)
0.51 (13.00)	0.39 (10.00)

FRONT VIEW

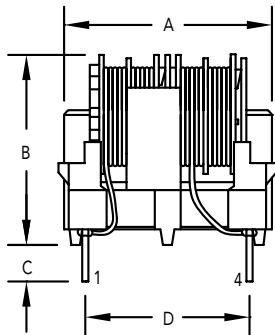

SIDE VIEW

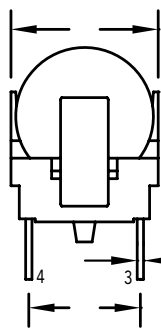

RECOMMENDED LAND PATTERN

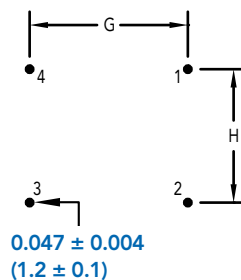

PIN DIAMETER
0.031 ± 0.004
(0.8 ± 0.1) (4PL)

SCHEMATIC

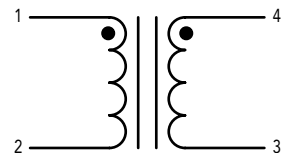

RENCO ELECTRONICS INC.

595 International Place, Rockledge, FL 32955-4200 USA • www.rencousa.com • ISO 9001 Certified
Toll Free Engineering Hot Line: 800.645.5828 • P: 321.637.1000 • F: 321.637.1600



RL-9750-1VM

Renco Part No. RL-9750-1VM	Inductance (mH) Min.	DCR (Ohms) ± 20%	I _{rms} (A) Max.
RL-9750-1VM-0.82	0.82	0.072	2.0
RL-9750-1VM-1.2	1.2	0.119	1.6
RL-9750-1VM-1.8	1.8	0.162	1.5
RL-9750-1VM-2.2	2.2	0.186	1.3
RL-9750-1VM-2.7	2.7	0.248	1.1
RL-9750-1VM-3.3	3.3	0.277	1.1
RL-9750-1VM-3.9	3.9	0.305	1.0
RL-9750-1VM-5.6	5.6	0.504	0.8
RL-9750-1VM-6.8	6.8	0.571	0.7
RL-9750-1VM-8.2	8.2	0.681	0.6
RL-9750-1VM-10.0	10.0	0.782	0.6
RL-9750-1VM-18.0	18.0	1.271	0.5
RL-9750-1VM-22.0	22.0	1.707	0.4
RL-9750-1VM-33.0	33.0	2.691	0.3

NOTES:

1. ELECTRICAL SPECIFICATIONS MEASURED AT 25°C
2. I_{rms} - CURRENT THAT CAUSES THE TEMPERATURE TO RISE APPROX. 40°C ABOVE AMBIENT OF 25°C
3. INDUCTANCE TESTED AT 10 kHz, 0.1 V_{rms}

