



RL-5022-HC

UNSHIELDED ULTRA HIGH CURRENT

DESCRIPTION

- Unshielded High Current SMD Inductor

ENVIRONMENTAL DATA

- Storage temperature range: -55°C to +130°C
- Operating temperature range: -40°C to +130°C

PACKAGING INFORMATION

- Packaging information: pg. 489

FEATURES & APPLICATIONS

- Low-cost, high-performance inductor
- Super low resistance with high current rating
- Excellent as DC-DC converter used in notebook computers and step-up or step-down converters

Verify operation with sample in actual circuit. Order samples at www.rencousa.com.

MECHANICAL DIMENSIONS

U.S. Standard (mm)

PART NUMBER	A (MAX.)	B (MAX.)	C (MAX.)	D (REF.)	E (REF.)	F (REF.)
RL-5022-HC	0.88 (22.35)	0.64 (16.26)	0.32 (8.00)	0.13 (3.18)	0.34 (8.64)	0.57 (14.35)

PART NUMBER	PART WEIGHT
RL-5022-HC	3.0g (0.11oz)

TOP VIEW

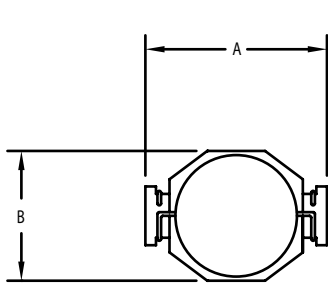

SIDE VIEW

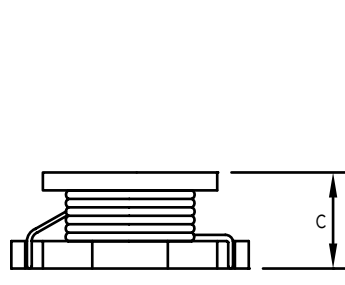

RECOMMENDED LAND PATTERN

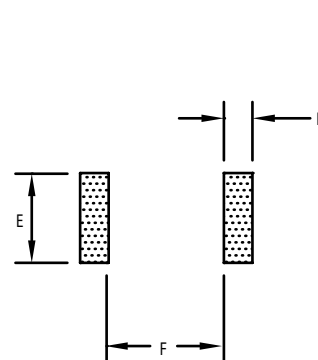

SCHEMATIC

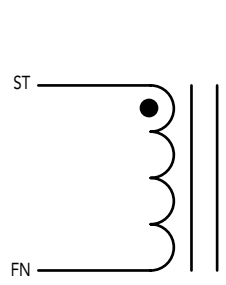

RECO ELECTRONICS INC.

595 International Place, Rockledge, FL 32955-4200 USA • www.rencousa.com • ISO 9001 Certified
Toll Free Engineering Hot Line: 800.645.5828 • P: 321.637.1000 • F: 321.637.1600



RL-5022-HC

Renco Part No. RL-5022-HC	Inductance (μ H)	DCR Max. (Ohms)	Isat (A)	Irms (A)	SRF Typ. (MHz)
RL-5022-HC-R78M	0.78 \pm 20%	0.0026	30.0	15.0	156.0
RL-5022-HC-1R5M	1.5 \pm 20%	0.004	25.0	15.0	100.0
RL-5022-HC-2R2M	2.2 \pm 20%	0.006	20.0	12.0	75.0
RL-5022-HC-3R3M	3.3 \pm 20%	0.008	17.0	10.0	60.0
RL-5022-HC-3R9M	3.9 \pm 20%	0.010	15.0	9.00	55.0
RL-5022-HC-4R7M	4.7 \pm 20%	0.014	13.0	8.40	40.0
RL-5022-HC-6R0M	6.0 \pm 20%	0.017	12.0	7.50	35.0
RL-5022-HC-7R8M	7.8 \pm 20%	0.018	11.0	7.50	35.0
RL-5022-HC-100M	10.0 \pm 20%	0.026	10.0	6.00	28.0
RL-5022-HC-150M	15.0 \pm 20%	0.032	8.0	4.40	20.0

OTHER NON-STANDARD INDUCTANCE VALUES ARE AVAILABLE
TO MEET YOUR EXACT REQUIREMENTS

NOTES:

1. ELECTRICAL SPECIFICATIONS MEASURED AT 25°C
2. Isat - DC CURRENT THAT WILL CAUSE INDUCTANCE
TO DROP BY 10%
3. Irms - CURRENT THAT CAUSES THE TEMPERATURE TO
RISE APPROX. 40°C ABOVE AMBIENT OF 25°C
4. INDUCTANCE TESTED AT 100 kHz, 0.1 Vrms

